

# INSTALLATION INSTRUCTIONS

**MODEL**

**300506S**

**SUBMERSIBLE  
UTILITY PUMP**

2190 Dagenais Blvd. West  
LAVAL (QUEBEC)  
CANADA  
H7L 5X9

TEL : 514.337.4415  
FAX : 514.337.4029  
info@burcam.com

Your pump has been carefully packaged at the factory to prevent damage during shipping. However, occasional damage may occur due to rough handling. **Carefully inspect your pump** for damages that could cause failures. Report any damage to your carrier or your point of purchase.

Please read these instructions carefully. **Failure** to comply to instructions and **designed** operation of this system, may **void** the warranty.

## NOTICE

This unit has been designed to pump water only. This unit is not designed for applications involving salt water, brine or any other liquids including petroleum products. Use with salt, brine or any other liquids including petroleum products will void the warranty.

## ELECTRICAL CONNECTION

For pumping systems using more than one pump, each pump needs to be connected to its own dedicated circuit protected by a fuse or breaker. The use of dedicated circuits will allow the other pumps to continue functioning even if the fuse or breaker of one of the pumps trips .



## SAFETY INSTRUCTIONS:

This fine pump that you have just purchased is designed using the finest materials and workmanship. Before installation and operation, we recommend the following procedures:

- A** CHECK WITH YOUR LOCAL ELECTRICAL AND PLUMBING CODES TO ENSURE YOU COMPLY WITH THE REGULATIONS. THESE CODES HAVE BEEN DESIGNED WITH YOUR SAFETY IN MIND. BE SURE YOU COMPLY WITH THEM.
- B** WE RECOMMEND THAT THE PUMP BE USED ON A SEPARATE CIRCUIT LED FROM THE HOME'S ELECTRICAL DISTRIBUTION PANEL, AND WHICH IS PROTECTED BY A FUSE OR A CIRCUIT BREAKER. THE MOTOR MUST BE SECURELY PLUGGED INTO A PROPER 'GFCI' ELECTRICAL OUTLET. CONSULT A LICENSED ELECTRICIAN FOR ALL WIRING.
- C** THE GROUND TERMINAL ON A THREE PRONG PLUG SHOULD NEVER BE REMOVED. IT IS DESIGNED FOR YOUR PROTECTION.
- D** NEVER MAKE ADJUSTMENTS TO ANY ELECTRICAL APPLIANCE OR PRODUCT WITH THE POWER CONNECTED. DO NOT ONLY UNSCREW THE FUSE OR TRIP THE BREAKER, REMOVE THE PLUG FROM THE RECEPTACLE.

### MONTHLY MANDATORY CHECK-UP :

1. Inspect the pump for any obvious condition that necessitates cleaning, correction, adjustment or repair.
2. Clear the surroundings of any paper, leaves or other debris that might clog the input openings. Remove anything that might float into the suction area.
3. Ensure that the pump is secure and vertical for proper operation.
4. Ensure that there is adequate clearance from any combustible materials or structure. Stored materials must be kept away from the pump. Shelves or cabinet structures must not be in close proximity to the pump.
5. Test the 'GFCI' outlet by pressing its test switch. This should prove that the outlet is energized and will trip off to protect against a ground fault. Be sure to reset the 'GFCI' by pressing its reset switch.
6. Put the necessary pail of water in the sump to prove that the pump will start when required and that any check valve present will permit effluent to flow.
7. Observe that the plumbing can carry the effluent safely out of the residence.

### APPLICATION

- This submersible utility pump is designed for a portable application, for dewatering around homes.
- This pump is great for water transfer from a basin, pool cover, flooded floor, flat roof.

### FEATURES

- Non corrosive material.
- Stainless steel mechanical rotary seal.
- Thermal and overload protection.
- 1/6 HP, 115 V AC, 60Hz, 0.8 A (1.6 A at start up)

### CAPACITIES

	<u>LPH</u>		<u>US GPH</u>
1.5m	2080	5'	740
3.0m	1900	10'	500
4.5m	375	15'	100

FRICTION LOSS IN  
PIPE NOT INCLUDED

#### NOTICE

This unit is not designed for applications to pump salt water or brine.  
Use with salt water or brine will void warranty.

## TYPICAL APPLICATIONS FOR THIS PRODUCT

### STEP 1

Screw the garden hose to the pump discharge.

### STEP 2

Install the pump at the appropriate place to remove water.

### STEP 3

Connect the plug to the electrical outlet.

### STEP 4

Note that this electronic switch will continue to provide electricity to the pump for 30 seconds after the switch lever drops down, to allow the water to continue to drain through the pump's bottom suction feature.

**Never run the pump dry**

### STEP 5

Remove the plug from the electrical outlet to immediately stop.

#### • TO DRAIN POOL AND POOL COVER

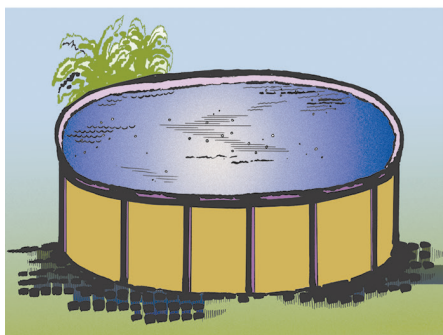

#### • TO DRAIN SPA

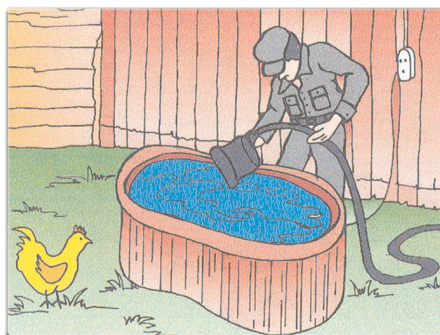

#### • TO DRAIN FLOODED BASEMENT

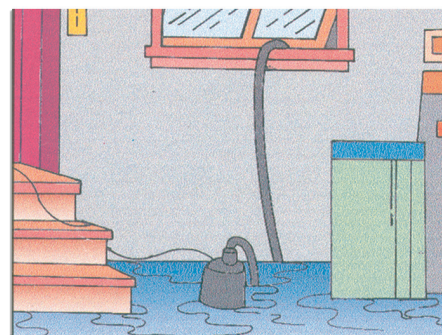

## REPAIR PARTS

REF.	PART	DESCRIPTION
1	300442N	Pump Power Cord
2	300463	Screws & washers (2)
3	300456	Cord Clasp
4	310942	Motor housing
5	310950	Capacitor
6	310945	Assembled motor
7	310944	Pump casing screws (6)
8	310948	Impeller
9	300443	Strainer
10	300463	Strainer screws (3)
11	300453	Impeller nut
12	310952	Mechanical seal
13	310943	Pump casing
14	450464	Switch (Not shown)

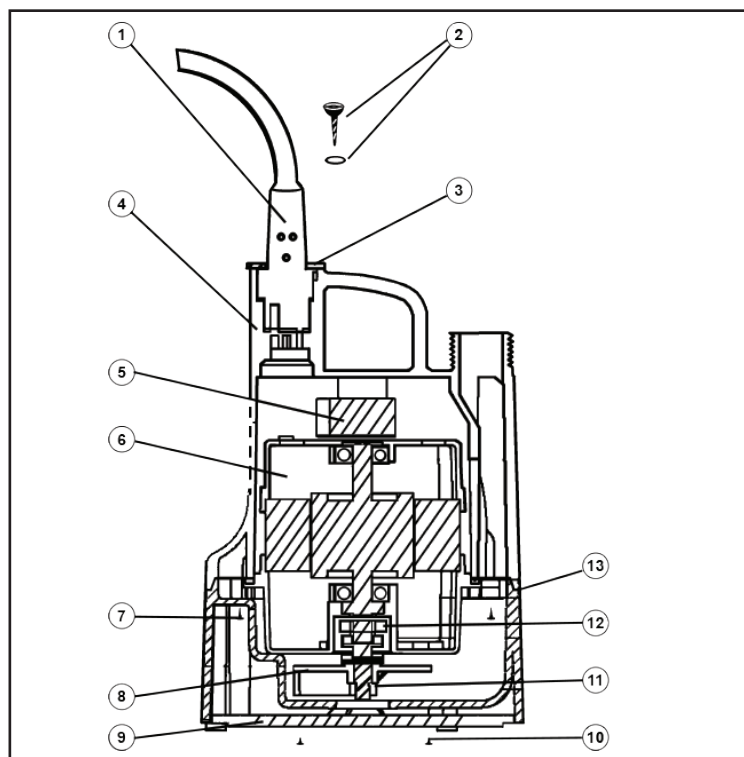

Repair parts may be ordered from your authorized point of sale or from BUR-CAM PUMPS

## TROUBLE SHOOTING GUIDE CHECKLIST

NEVER MAKE ADJUSTMENTS TO ANY ELECTRICAL APPLIANCE OR PRODUCT WITH THE POWER CONNECTED. DON'T JUST UNSCREW THE FUSE OR TRIP THE BREAKER, REMOVE THE POWER FROM THE RECEPTACLE.

### TROUBLE

### PROBABLE CAUSE

### ACTION

**Motor  
does  
not run.**

Blown fuse  
Tripped breaker  
Plug disconnected  
Corroded plug  
Low water level  
Thermal overload  
  
Defective motor

Replace  
Reset  
Re-install  
Clean prongs  
Add water and verify  
Unplug the pump for 15 minutes  
than restart.  
Replace/repair

**Pump does not  
deliver to full  
capacity.**

Jammed impeller  
Blocked suction/inlet  
Discharge leak  
Blocked line/pipe  
Worn impeller  
Defective motor

Clean  
Check for debris and clean  
Repair  
Check for debris or ice  
Repair/replace  
Replace

### TO THE END CONSUMER

*If you have any problems with the product, before advising the store, where you've purchased the pump, please contact us at 514 337-4415 , and ask for our sales department, and they will be pleased to help you with any questions you might have, concerning your installation.*